

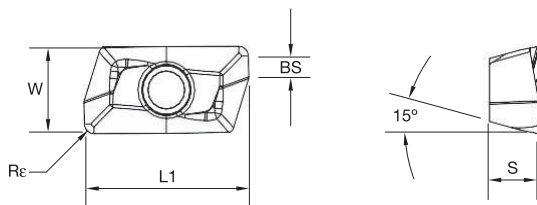

XDCT-ALP



● first choice
○ alternate choice

P	<input checked="" type="checkbox"/>	<input type="checkbox"/>	<input type="checkbox"/>
M	<input checked="" type="checkbox"/>	<input type="checkbox"/>	<input type="checkbox"/>
K	<input checked="" type="checkbox"/>	<input type="checkbox"/>	<input type="checkbox"/>
N	<input checked="" type="checkbox"/>	<input checked="" type="checkbox"/>	<input checked="" type="checkbox"/>
S	<input checked="" type="checkbox"/>	<input type="checkbox"/>	<input type="checkbox"/>
H	<input type="checkbox"/>	<input type="checkbox"/>	<input type="checkbox"/>

■ XDCT-ALP

Shoulder Mills

catalogue number	cutting edges	L1	BS	S	W	Re	WN10HM	WN25PM
XDCT170404PEFRALP	2	19,15	2,62	4,90	9,60	0,40	6007341	6007220
XDCT170408PEFRALP	2	19,15	2,22	4,90	9,60	0,80	6007345	6007344
XDCT170412PEFRALP	2	19,16	1,82	4,90	9,60	1,20	6007342	6001537
XDCT170416PEFRALP	2	19,17	1,42	4,90	9,60	1,60	6001256	6001254
XDCT170420PEFRALP	2	19,17	1,01	4,90	9,60	2,00	6001252	6001254
XDCT170424PEFRALP	2	19,17	0,63	4,90	9,60	2,40	6001252	6001254
XDCT170432PEFRALP	2	18,85	—	4,88	9,59	3,20	6001238	6001240
XDCT170440PEFRALP	2	18,33	—	4,87	9,59	4,00	6001238	6001240