

Copy Mills • M170™ Series

Shell Mills • RD12T3..

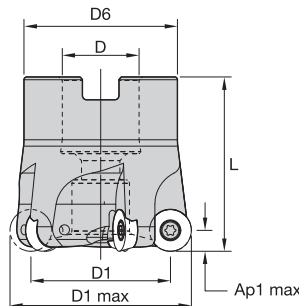

- Premium nickel-coated bodies.
- Designed for maximum performance.
- Ideally suited for die and mould manufacturing.

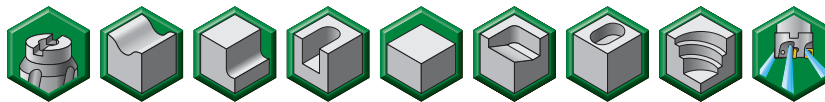

Shell Mills

| order number | catalogue number | D1 max | D1 | D | D6 | L | Ap1 max | Z | max ramp angle | max RPM | coolant supply | kg |
|--------------|------------------|--------|----|----|----|----|---------|---|----------------|---------|----------------|------|
| 3930968 | M170D040Z04RD12 | 40 | 28 | 16 | 37 | 40 | 6,0 | 4 | 9.3° | 7000 | Yes | 0,22 |
| 3930970 | M170D050Z05RD12 | 50 | 38 | 22 | 44 | 40 | 6,0 | 5 | 6.1° | 7950 | Yes | 0,32 |
| 3930972 | M170D052Z05RD12 | 52 | 40 | 22 | 44 | 50 | 6,0 | 5 | 4.5° | 7600 | Yes | 0,44 |
| 3930975 | M170D063Z06RD12 | 63 | 51 | 22 | 44 | 40 | 6,0 | 6 | 4.5° | 6300 | Yes | 0,45 |
| 3930976 | M170D066Z06RD12 | 66 | 54 | 27 | 60 | 50 | 6,0 | 6 | 4.5° | 6030 | Yes | 0,81 |
| 3930979 | M170D080Z07RD12 | 80 | 68 | 27 | 60 | 50 | 6,0 | 7 | 3.5° | 4900 | Yes | 0,97 |
| 3930981 | M170D100Z08RD12 | 100 | 88 | 32 | 80 | 55 | 6,0 | 8 | 2.2° | 3900 | Yes | 1,95 |

Spare Parts



| D1 max | insert screw | Nm | clamp screw | Torx driver | low-head cap screw | low-head cap screw with coolant groove | socket-head cap screw | socket-head cap screw with coolant groove |
|--------|--------------|-----|-------------|-------------|--------------------|----------------------------------------|-----------------------|-------------------------------------------|
| 40 | 193.342 | 3,5 | 193.338 | 12148082400 | — | — | MS1294 | MS1294CG |
| 50 | 193.342 | 3,5 | 193.338 | 12148082400 | 129.025 | — | — | MS2072CG |
| 52 | 193.342 | 3,5 | 193.338 | 12148082400 | 129.025 | — | — | MS2072CG |
| 63 | 193.342 | 3,5 | 193.338 | 12148082400 | 129.025 | — | — | MS2072CG |
| 66 | 193.342 | 3,5 | 193.338 | 12148082400 | — | — | MS2038 | MS2038CG |
| 80 | 193.342 | 3,5 | 193.338 | 12148082400 | — | — | MS2038 | MS2038CG |
| 100 | 193.342 | 3,5 | 193.338 | 12148082400 | MS1254 | MS1254CG | — | — |

NOTE: Socket-head cap screw, socket-head cap screw with coolant groove, low-head cap screw with coolant groove, and Torx driver must be ordered separately.