

# Copy Mills • M100™ Series

Shell Mills • RC1606..

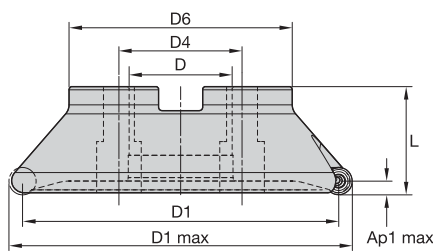

- General purpose face and copy milling.
- Anti-rotation feature for top security.

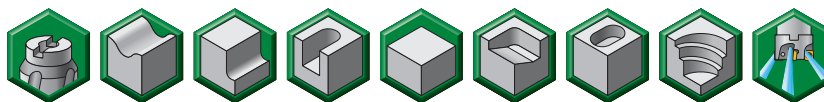

## Shell Mills

| order number | catalogue number | D1 max | D1  | D  | D4  | D6  | L  | Ap1 max | Z  | max ramp angle | max RPM | coolant supply | kg   |
|--------------|------------------|--------|-----|----|-----|-----|----|---------|----|----------------|---------|----------------|------|
| 2021358      | 12391023400      | 50     | 34  | 22 | —   | 40  | 40 | 8,0     | 4  | 6.0°           | 13000   | Yes            | 0,20 |
| 2021359      | 12391023600      | 52     | 36  | 22 | —   | 40  | 40 | 8,0     | 4  | 5.8°           | 13000   | Yes            | 0,30 |
| 2021357      | 12391023200      | 63     | 47  | 27 | —   | 48  | 40 | 8,0     | 5  | 4.0°           | 12000   | Yes            | 0,20 |
| 2021360      | 12391023800      | 66     | 50  | 27 | —   | 48  | 40 | 8,0     | 5  | 3.8°           | 12000   | Yes            | 0,30 |
| 2021352      | 12391022000      | 80     | 64  | 27 | —   | 60  | 50 | 8,0     | 6  | 2.8°           | 10000   | Yes            | 0,90 |
| 2021353      | 12391022200      | 100    | 84  | 32 | —   | 78  | 50 | 8,0     | 7  | 2.3°           | 9000    | No             | 1,20 |
| 2021354      | 12391022400      | 125    | 109 | 40 | —   | 89  | 50 | 8,0     | 8  | 1.8°           | 8000    | No             | 1,80 |
| 2021355      | 12391022600      | 160    | 144 | 40 | 67  | 90  | 63 | 8,0     | 9  | 1.3°           | 7000    | No             | 2,90 |
| 2021356      | 12391022800      | 200    | 184 | 60 | 102 | 130 | 63 | 8,0     | 11 | 0.8°           | 6000    | No             | 0,30 |

## Spare Parts



| D1 max | insert screw | Nm  | Torx driver | socket-head cap screw | socket-head cap screw with coolant groove |
|--------|--------------|-----|-------------|-----------------------|---|
| 50     | 12148007200  | 4,0 | 12148007500 | 125.025               | MS1234CG                                  |
| 52     | 12148007200  | 4,0 | 12148007500 | 125.025               | MS1234CG                                  |
| 63     | 12148007200  | 4,0 | 12148007500 | 125.230               | MS2038CG                                  |
| 66     | 12148007200  | 4,0 | 12148007500 | 125.230               | MS2038CG                                  |
| 80     | 12148007200  | 4,0 | 12148007500 | 125.230               | MS2038CG                                  |
| 100    | 12148007200  | 4,0 | 12148007500 | —                     | —   |
| 125    | 12148007200  | 4,0 | 12148007500 | —                     | —   |
| 160    | 12148007200  | 4,0 | 12148007500 | —                     | —   |
| 200    | 12148007200  | 4,0 | 12148007500 | —                     | —   |

NOTE: All spare parts except the insert screws must be ordered separately.